

CLIENT
GOLDCORAL PTY LTD

PROJECT PROPOSED SUBDIVISION OF
LOTS 276 & 277 ON DP755624,
LOT 163 ON DP831052, CROWN PUBLIC
ROAD RESERVE (BETWEEN LOT 163
DP831052 AND LOT 276 DP755624) AND
CROWN FORESHORE RESERVE
(ADJACENT TO EVANS RIVER)

LOCAL AUTHORITY
RICHMOND VALLEY

NOTES
(i) This plan was prepared for the purpose and exclusive use of
GOLDCORAL PTY LTD to accompany an application to RICHMOND
VALLEY for approval to reconfigure the land described in this plan and is
not to be used for any other purpose or by any other person or
corporation.
LandPartners Pty Ltd accepts no responsibility for any loss or damage
suffered howsoever arising to any person or corporation who may use or
rely on this plan in contravention of the terms of this clause or clauses (i),
or (iii) hereof.
(ii) The dimensions, areas, number of lots, size and location of
improvements & flood information (if shown) are approximate only and
may vary.
(iii) This plan may not be copied unless these notes are included.

STAGE	No. OF LOTS	NEW ROAD	AREA OF PARK	TOTAL AREA
-	-	-	-	-
TOTAL				

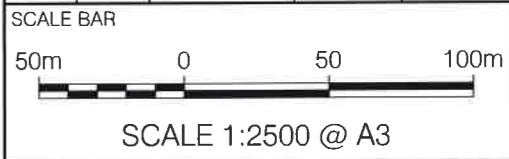

LANDPARTNERS
built environment consultants

Brisbane Office
Level 1 - CDOP6
18 Little Cribb Street,
Milton Qld 4064
PO Box 1399
Milton Qld 4064

p: (07) 3842 1000
f: (07) 3842 1001
e: info@landpartners.com.au
w: www.landpartners.com.au



LEVEL DATUM	NA		
LEVEL ORIGIN	NA		
CONTOUR INTERVAL	NA		
DRAWN	CGW	DATE	23/03/2020
CHECKED	MEA	DATE	23/03/2020
APPROVED	CGW	DATE	23/03/2020

UDN BRJD6396-100-38-5 SHEET 1 OF 1

Resumed land vested in fee
simple in the Minister for Public
Works as per Government Gazette
dated 11 May 1894

NOTE: ALL DIMENSIONS AND AREAS ON THIS PLAN ARE SUBJECT TO SURVEY AND REQUIREMENTS FOR LODGEMENT OF SURVEY PLANS IN THE DEPARTMENT.

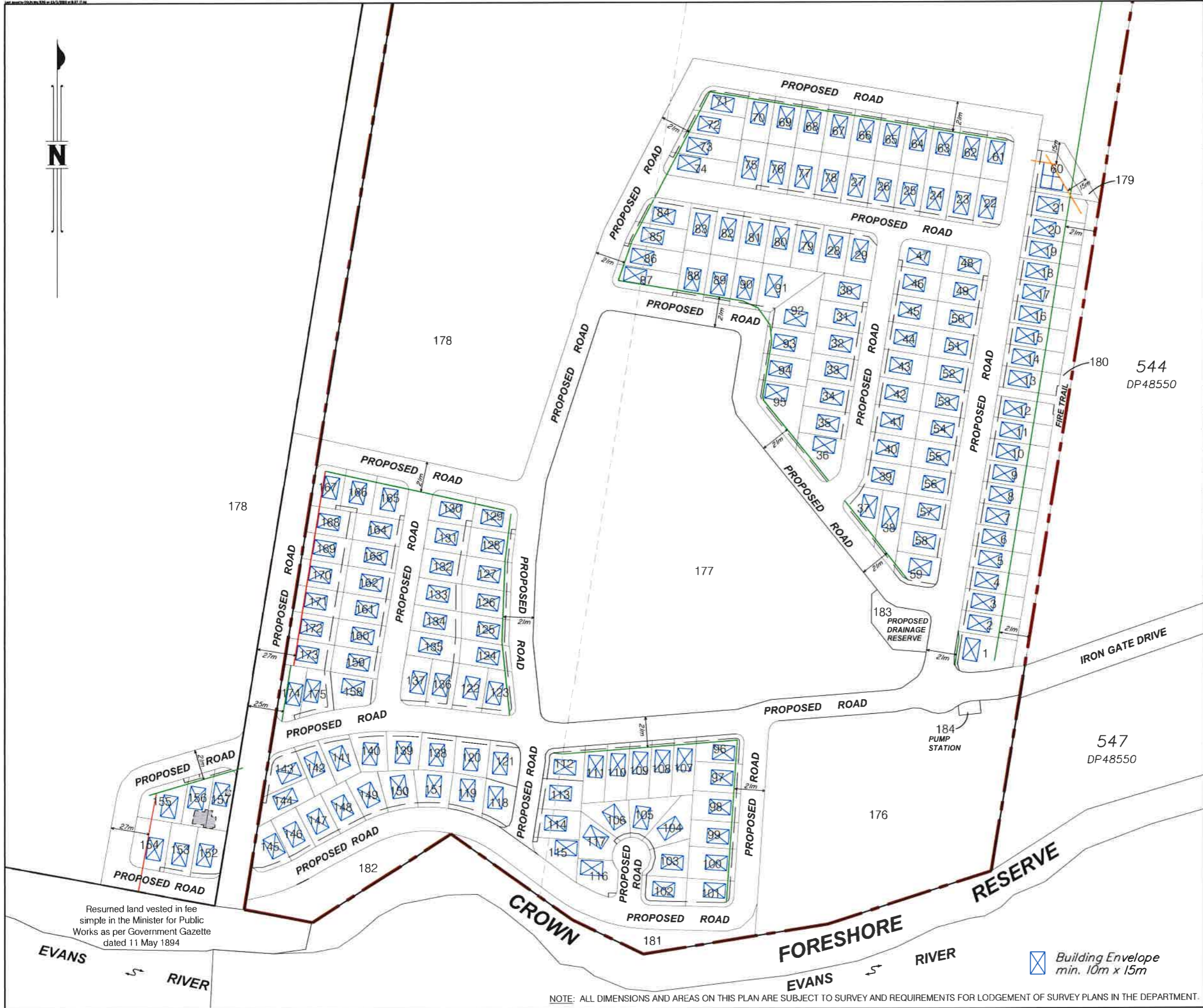

CLIENT
GOLDCORAL PTY LTD

PROJECT
 BUSHFIRE SETBACK PLAN OVER PROPOSED SUBDIVISION OF LOTS 276 & 277 ON DP755624, LOT 163 ON DP831052, CROWN PUBLIC ROAD RESERVE (BETWEEN LOT 163 DP831052 AND LOT 276 DP755624) AND CROWN FORESHORE RESERVE (ADJACENT TO EVANS RIVER)

LOCAL AUTHORITY
 RICHMOND VALLEY

NOTES

(i) This plan was prepared for the purpose and exclusive use of GOLDCORAL PTY LTD to accompany an application to RICHMOND VALLEY for approval to reconfigure the land described in this plan and is not to be used for any other purpose or by any other person or corporation. LandPartners Pty Ltd accepts no responsibility for any loss or damage suffered howsoever arising to any person or corporation who may use or rely on this plan in contravention of the terms of this clause or clauses (ii) or (iii) hereof.

(ii) The dimensions, areas, number of lots, size and location of improvements & flood information (if shown) are approximate only and may vary.

(iii) This plan may not be copied unless these notes are included.

STAGE	No. OF LOTS	NEW ROAD	AREA OF PARK	TOTAL AREA
-	-	-	-	-
TOTAL				

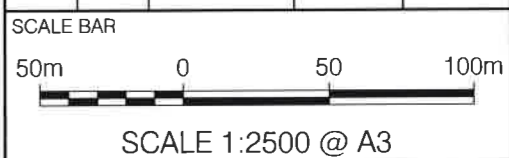

Brisbane Office
 Level 1 - CDOP6
 18 Little Cribb Street,
 Milton Qld 4064
 PO Box 1399
 Milton Qld 4064

p: (07) 3842 1000
 f: (07) 3842 1001
 e: info@landpartners.com.au
 w: www.landpartners.com.au



LEVEL DATUM	NA		
LEVEL ORIGIN	NA		
CONTOUR INTERVAL	NA		
DRAWN	CGW	DATE	23/03/2020
CHECKED	MEA	DATE	23/03/2020
APPROVED	CGW	DATE	23/03/2020
UDN	BRJD6396-100-45-2		
	SHEET 1 OF 1		

Returned land vested in fee simple in the Minister for Public Works as per Government Gazette dated 11 May 1894

NOTE: ALL DIMENSIONS AND AREAS ON THIS PLAN ARE SUBJECT TO SURVEY AND REQUIREMENTS FOR LODGEMENT OF SURVEY PLANS IN THE DEPARTMENT.

Building Envelope min. 10m x 15m